

FDM camping

Camping in Denmark

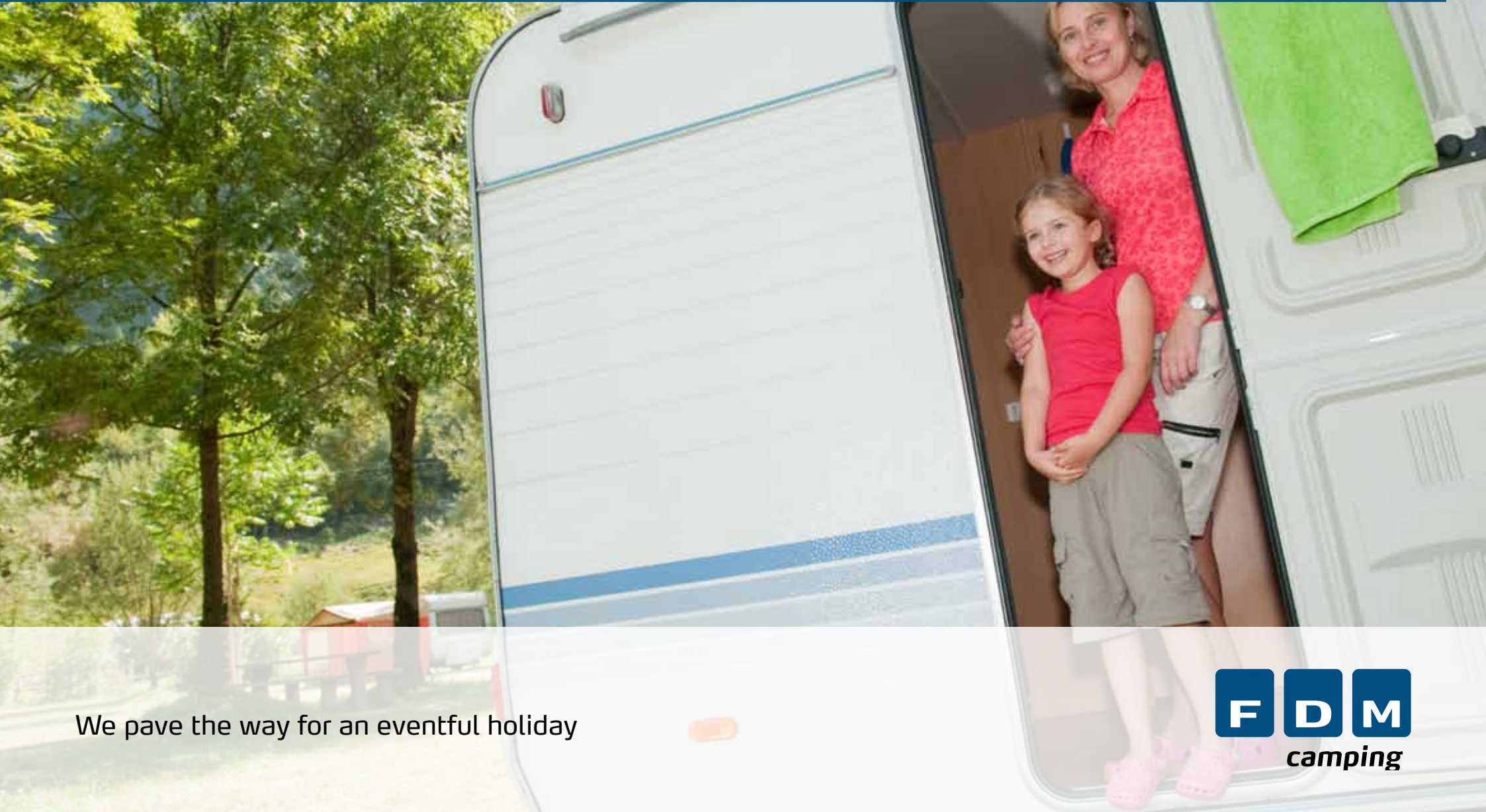

We pave the way for an eventful holiday



FDM Camping

- looks after your whole holiday

FDM's camping concept looks after your whole holiday;

- FDM has nine campsites in Denmark – you receive a discount at these
- FDM cooperates with approx.. 75 campsites across Denmark – you receive a discount at these
- FDM cooperates with a wide range of international campsites – you receive a discount at these
- FDM offers free internet access at all its campsites
- FDM insurance covers both your caravan and your car
- FDM roadside assistance protects you- even when you travel abroad
- FDM's Driving Skills courses focus on the skills you need, especially when you're towing a caravan
- FDM's online shop sells Camping Key Europe and camping guides, including motorways and environmental marks
- FDM provides legal and technical advice about caravans and campers
- FDM can provide a Tempo 100 approval – so contact FDM if you plan to drive up to 100kph with a caravan
- FDM holiday services provide good advice and a wealth of information for planning your holiday
- FDM cooperates with a wide range of shops selling camping products – you receive a discount at these
- FDM cooperates with a range of selected caravan centres on caravan testing – you receive a discount at these
- FDM's trip planner shows roads throughout Europe and will guide you to your nearest campsite

Stay connected on your holiday
– All FDM campsites have wireless internet

Camping for the whole family

FDM's campsites are the perfect setting for a great holiday experience - and at FDM we do our utmost to create the very best environment for you and your family to enjoy a relaxed and unforgettable holiday. All FDM campsites have a wealth of facilities and activities on offer and there is always plenty to look forward to, whether you are staying in a caravan, a cabin or a tent.

Kids can go wild in play areas with bouncy castles and climbing walls. They can meet farm animals and play mini-golf, all whilst the adults relax in one of the cafes or on the golf course. Several FDM campsites also have swimming pools and wellness areas.

Camping is a holiday for everyone

Camping is a very relaxed form of vacationing for anyone and everyone who wants a holiday with a focus on enjoyment, togetherness and great experiences.

Use our campsite brochure to help you plan your next camping holiday. Have a great time.

Regards
FDM Camping



Ålbæk Strand Camping

- Holiday close to Skagen



Star requirement symbols

Activity symbols

Information symbols

Check prices and opening times at
Ålbæk Strand på www.fdmcamping.dk



Ålbæk Strand Camping is in a beautiful nature area with woods and stunning white beaches just outside the 'door', and has plenty of activities for both children and adults. The campsite has a large play area with bouncy castles, a playing field, moon cars, mini-golf, table tennis, beach volleyball, a site for bonfires and several more for barbecues. The beach, which gives the campsite its name, deserves a special mention. Several kilometres of fine white sand, combined with calm shallow waters make the beach perfect for the kids.

Once settled at Ålbæk you'll also find that there's plenty to see and do in the local area. The town was once a fishing port but is now both a fishing port and a marina. It is well worth a visit, and maybe you can even catch something for dinner. Ålbæk also offers beautiful natural resources and countless excursions. You can go hiking in the beautiful Ålbæk Klitplantage, a dune plantation, or visit Råbjerg Mile - a huge sand dune and major tourist destination. And you mustn't forget Skagen - Denmark's northernmost town is just 20km from the campsite - and in Skagen you can find everything from wonderful restaurants and fascinating shops to museums featuring famous Skagen artists' works. Or take a tour to Grenen, where the Skagerrak and the Kattegat meet.

The following are available for hire at the campsite:

Cabins: E5, K5, H6, L5 and L5-1
Caravans: 542 PK. See page 9 for more info



Hegedal Strand Camping

- Camping at the tip of Jutland

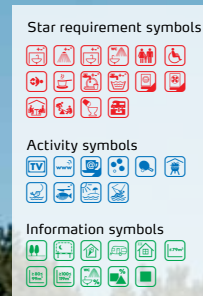

Check prices and opening times at
Hegedal Strand Camping på www.fdmcamping.dk

Hegedal Strand Camping is a wonderful family campsite set in natural surrounds on the northern tip of Jutland. The campsite lies directly on a beautiful, child-friendly beach and also offers a good play area with outdoor table tennis and a bouncy castle. Hegedal Strand Camping is equipped with all the amenities to make your holidays a treat, including excellent kitchen and bathroom facilities, as well as good shopping opportunities on site.

The ever popular Djurs Summerland amusement park is located not far from the site and the family can easily spend a whole day enjoying the numerous attractions. Ebeltoft is certainly worth a visit too. It lies close to Hegedal Strand Camping and has both the smallest and oldest city hall, as well as the Frigate Jylland, the world's oldest warship. Ree Park - Ebeltoft Safari is also a popular destination, as are the exciting Kattegat Centre with its sharks, and Randers Rainforest, featuring tropical animals.

If you like golf it is just 10km to Allingåbro, which has attractive courses. There is also a lot to see and do in Aarhus, the capital of Jutland, for example Den Gamle By and Aros Art Museum, and with a little planning you can easily see Aarhus in a day trip.

The following are available for hire at the campsite:

Cabins: K5 and L5.
See page 9 for more info



Billund Camping

- Next-door to Legoland and Lalandia

Billund Camping · Ellehammers Allé 2 · 7190 Billund
Tel. (+45) 73 33 15 21 · Fax (+45) 75 35 37 36
c-billund@fdm.dk



Billund Camping is one of Denmark's most modern and well run campsites. Spread over 14 hectares, you'll find plenty of room to breathe and space for the whole family. The campsite also offers a wealth of activities. You'll find everything from a maritime activity playground to a mini zoo with horses, donkeys, calves, goats and rabbits, where you and your children can meet the animals. There's also mini golf and play areas, as well as TV and recreation rooms. When the day's activities are over, you can dine at the campsite's exciting family restaurant, which also offers a special children's buffet. If you prefer to eat 'at home', you can buy everything you need at Billund Camping's well-stocked supermarket. The campsite features a great many sheltered and cozy nooks, but there are also common areas which help maintain the great atmosphere.

Legoland! Lalandia! No more needs be said. But apart from these two sure-fire hits with the kids, you can also find Givskud Zoo and Lion park close to the campsite. For our adult guests Billund Camping also welcomes you to Billund Bad and Wellness, with numerous opportunities for self-indulgence. And for the golfers among you, Gyttegård Golf club is nearby.

The following are available for hire at the campsite:

Cabins: E5-1, K5, K5-1 and L5.

See page 9 for more info



Star requirement symbols



Activity symbols

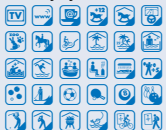

Information symbols

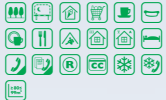

Check prices and opening times at
Billund Camping på www.fdmcamping.dk

Thurø Camping

- Camping on the South Funen Archipelago

Star requirement symbols



Activity symbols



Information symbols



Check prices and opening times at
Thurø Camping på www.fdmcamping.dk

Thurø Camping · Smørmosevej 7 · 5700 Svendborg
Tel. (+45) 62 20 52 54 · Fax (+45) 62 20 52 78
c-thuroe@fdm.dk



Children and activities are at the heart of Thurø Camping. The campsite on Funen is just a stone's throw from the beach, and here you will find a jetty and slide that will fling you straight into Svendborgsund. There are plenty of sheltered sites around the campsite. There is also a large play area with a bouncy castle for the kids, as well as a petanque piste for adults. You can cook dinner on one of the many grills around the site, where tables and benches are also provided. Thurø Camping is also a neighbour to Europe's most entertaining mini golf course.

Thurø Camping lies very close to one of Denmark's most beautiful towns, Svendborg. A quick trip across Svendborgsund Bridge and you're in Svendborg - and ready for a stroll down the quaint and winding historic streets. While in Svendborg you can also take a tour into the world of natural history at Naturama. If your family likes visiting castles, two internationally renowned ones are close by. It is only 15km to Egeskov Castle, which houses numerous attractions and Valdemar Castle, dating from the 1640s, is even closer. If you fancy a drive, then take a trip to Odense, the capital of the region. The town has everything, from H.C. Andersen to shopping and a range of cultural attractions.

The following are available for hire at the campsite:

Cabins: E5, K5-2, H6, L5 and L5-1
Caravans: 542 PK, 512 UP and 563 TK. See page 9 for more info



Nykøbing Nordstrand

- A stone's throw from the beach

Nykøbing Nordstrand Camping · Nordstrandsvej 107
4500 Nykøbing Sj. · Tel. (+45) 59 91 16 42
Fax (+45) 59 91 47 74 · c-nykoebing@fdm.dk



Star requirement symbols

Activity symbols

Information symbols

200 metres! This is how close Nykøbing Nordstrand Camping is to one of Denmark's finest beaches – surrounded by beautiful nature. The campsite itself is calm, harmonious and well-suited to families with children. The campsite offers everything from play areas and bouncy castles to motion studios and recreation rooms. For those interested in sport there is a playing field and opportunities for playing basketball and petanque. You can hire bikes and choppers at the campsite if you feel like visiting the local area.

The closest town is Nykøbing Sjælland. This is about 2km from the campsite and is a popular destination for tourists, with its welcoming pedestrian streets and rich shopping opportunities. There are some delightful driving trips to be found around Nykøbing Nordstrand Camping. Take a tour to the charming Rørvig, and don't miss the marina, which is always full of life. If it is culture and nature you're after, then a drive to Sjælland's Odde is a must, as is the 12th Century Dragsholm Castle. The park surrounding the castle is also open to visitors. There are no less than three golf courses for the golf enthusiasts too, a nine hole pay-and-play course, as well as two 18 hole courses at Fårevejle and Højby.

The following are available for hire at the campsite:

Cabins: K5, L5 and L5-1
Caravans: Contact the campsite about caravan rental.
See page 9 for more info



Check prices and opening times at
Nykøbing Nordstrand Camping på www.fdmcamping.dk

Holbæk Fjord Camping

- Combining camping and wellness

Holbæk Fjord Camping · Sofiesminde Allé 1
4300 Holbæk · Tel. (+45) 59 43 50 64
Fax (+45) 59 43 50 14 · c-holbaek@fdm.dk



Star requirement symbols



Activity symbols



Information symbols



The peaceful and idyllic Holbæk Fjord Camping has beautiful views across Isefjorden, the marina and the golf course. The campsite is very modern. It was opened only 18 years ago and is furnished with all the latest comforts. The shower and toilet facilities are of course excellent, but it is the wellness centre which really sets the campsite apart. There is a heated, covered pool, a sauna and a spa to help you truly unwind – and the facilities are free for campsite guests. The wellness centre is open year round, seven days a week, and there are a variety of ways to relax and unwind. You could book an hour with one of our centre's skilled masseurs for example.

The nearest town is Holbæk. In this fine old town you can experience a lively music and theatre scene, Denmark's only Turkish bath, the cultural historical museum "Andelslandsbyen Nyvang" and much more. The kids will also love visiting the Sommerland Sjælland amusement park which is close by. Holbaek is also centrally located in Sjælland, close to the motorway, and provides quick access to many other experiences, for example Copenhagen, if you want your holidays to have a touch of big city.

The following are available for hire at the campsite:

Cabins: K5, L5, L5-1 and Adria

Caravans: 563 TK.

See page 9 for more info

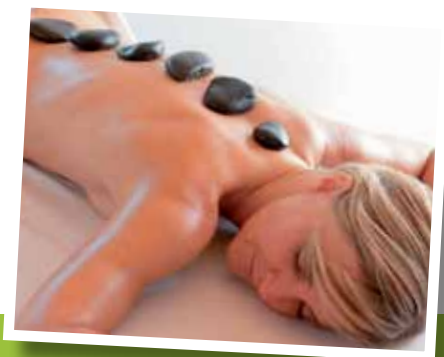

Check prices and opening times at
Holbæk Fjord på www.fdmcamping.dk

Tangloppen Camping

- Take a holiday with a sea-view



Star requirement symbols



Activity symbols

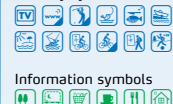

Information symbols



Check prices and opening times at
Tangloppen Camping på www.fdmcamping.dk

Tangloppen Camping · Ishøj Havn · 2635 Ishøj
Tel. (+45) 43 54 07 67 · Fax (+45) 43 54 07 64
c-tangloppen@fdm.dk



A peninsula in the Køge Bugt Strandpark creates the background to the campsite Tangloppen. The area is an integrated part of Ishøj Havn harbour, and as a guest at the campsite you are just 500m from more than 7km of fine sandy beaches. There is something for the whole family at Tangloppen. You can enjoy the beach and have a go at windsurfing, sailing or pleasure fishing. Or you can enjoy the many experiences that Denmark's capital city has to offer and combine your camping trip with a city break.

A trip to ARKEN will satisfy your artistic interests. The museum is close to Tangloppen and features the work of modern and contemporary artists and striking architecture, worth seeing just for itself. And you just can't miss a trip to the capital city during your stay at Tangloppen. Central Copenhagen is on 18km away so it's a short drive, or you can hop on the S-train instead. There are departures every 10 min from Ishøj Station. Once you get to Copenhagen the opportunities are limitless, whether you want museums, restaurants, shopping or even a sailing trip through the city's canals. If the city doesn't appeal, then take a trip to Roskilde, with its fantastic Viking Ship Museum and spectacular Cathedral.

The following are available for hire at the campsite:

Cabins: E4-2, S8, K5 and L5.
See page 9 for more info



Østersøparken Camping

- Camping on the South Sea Islands

Østersøparken Camping · Bøtøvej 243 · Bøtø
4873 Væggerløse · Tel. (+45) 54 13 67 86
Fax (+45) 54 13 61 90 · c-oestersoe@fdm.dk

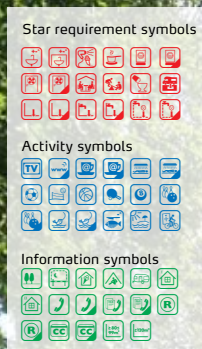

Østersøparken Camping is Denmark's southernmost campsite, right next to the beach and the Baltic Sea. The campsite has thought of everything; the centrally located play area has great facilities including moon cars, and a bouncy castle, and is a magnet for the kids. The play area lies next to a large playing field and the common room has a TV as well as dining facilities and table tennis. If you plan to eat outdoors then there is a barbeque and grill site available for use by all our guests.

Østersøparken Camping can also offer 24km of fine white Baltic sand, and the beach is a natural focal point for your camping holiday. You can swim or go for long walks, and the beach also offers opportunities for windsurfing and sea fishing. And when you want a break from the beach, you'll find an 18 hole golf course nearby. There's also Knuthenborg Safari park, a sure-fire winner with the kids, and Marielyst holiday centre is only 4.5km from the campsite. There are plenty of discos and shops, and a wide range of good restaurants here. And if you are in the mood to venture a little further, then the Cliffs of Møn are an impressive sight.

The following are available for hire at the campsite:

Cabins: E4-2, K5-2 and L5
Caravans: 542 PK.
See page 9 for more info



Check prices and opening times at
Østersøparken Camping på www.fdmcamping.dk

Bjerge Sydstrand Camping

- Camping close to a child-friendly beach

Bjerge Sydstrand Camping · Osvejlen 30
Bjerge Sydstrand · 4480 Fuglede
Tel. (+45) 59 59 78 03 · c-bjerge@fdm.dk



Wonderful holidays. Peaceful holidays. That's Bjerge Sydstrand Camping, in nature's beautiful surroundings. Bjerge Sydstrand campsite is run as it was in the 'good old days' – traditions such as eating together on long tables, shared barbecues and evening music are still alive, and very popular. The campsite lies beside a beautiful child-friendly beach where it is also possible to enjoy fishing. If you prefer 'put and take' fishing then you won't have far to travel to find a range of options.

The largest local town is Kalundborg, and it really is a must-see trip. There is a wealth of impressive historic buildings, including the ruins of Kalundberg fortress and the foundations of a square tower dating from Valdemar Atterdag's days. There's also a five-towered church, probably built by Esbern Snarre's daughter at the turn of the 13th Century. Kalundborg is also a lively market town with winding pedestrian streets full of shops, businesses and restaurants. If you venture a little further afield, you can take a trip on the veteran train between Høng and Gørlev, and Birkegårdens Gardens in Ruds Vedby is worth a visit for anyone interested in botany. The gardens also have play areas and facilities for children.

The following are available for hire at the campsite:

Cabins: L5
See page 9 for more info



Check prices and opening times at
Bjerge Sydstrand Camping på www.fdmcamping.dk

Skive Fjord Camping

- FDM cooperation campsite



Check prices and opening times at
Skive Fjord Camping på www.skivefjordcamping.dk



Skive Fjord Camping lies on the pretty southern slopes of the northern part of Skive town. The campsite is arranged in terraces which blend naturally into the landscape and give fantastic views over the fjord. With its unique position you'll find yourselves close to the town and yet surrounded by nature. There is something for everyone to be found in the town of Skive. You could go on a pirate ship in the fjord, visit limestone mines, haunted palaces and mansions and exciting castles. The town also offers glass-blowing, antiques and handicrafts, golf, trotting racing and a wide range of watersports. The campsite's excellent facilities and its focus on the family provide the perfect framework for an eventful, calm, relaxed and / or active holiday, where there is "room for everyone." At the campsite you can also find: a solar-heated swimming pool, kayak hire, an indoor activity room, basketball and football pitches, sites for open fires, water games and a grill terrace.

Around Skive you will find a wealth of good restaurants where you can enjoy traditional Danish food as well as French, Italian or Chinese cuisine. There's a great choice, whether you want to dine at an inn, restaurant, pizzeria, café or even a burger bar.

The following are available for hire at the campsite:
 Cabins: K5 and L5
 See page 9 for more info



Cabins and caravans

- Cozy cabins and caravans

E4-2 · 2 persons · 12 m²

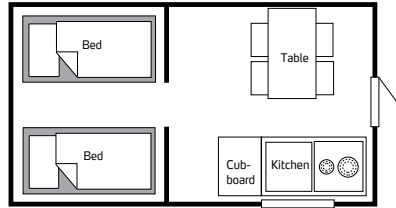

E5 · 5 persons · 12,5 m²

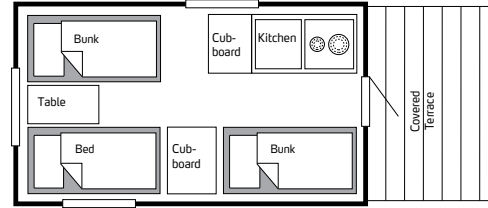

L5 · 5 persons · 25 m²

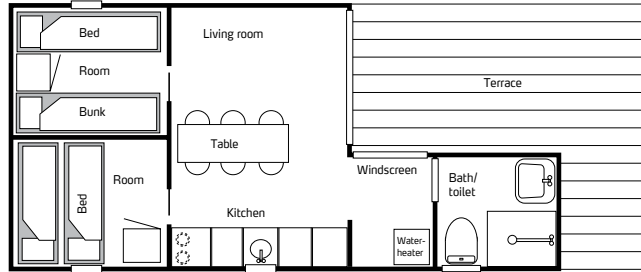

Adria · 5 persons · 23 m²

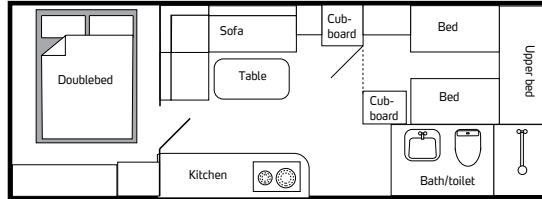

E5-1 · 5 persons · 13 m²

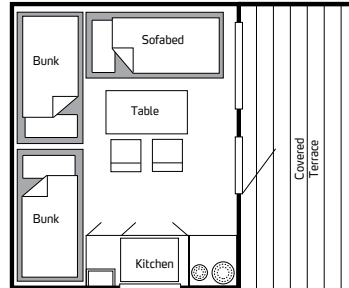

K5-1 · 5 persons · 18 m²

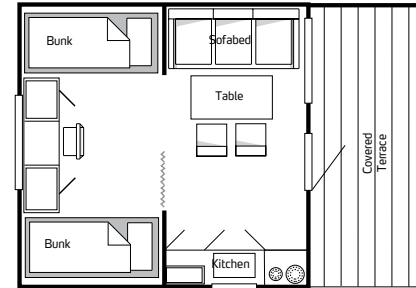

K5 · 5 persons · 18 m²

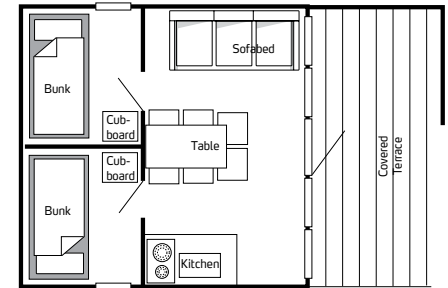

General information about cabins

FDMs cabins are heated by electricity, and are well insulated. They contain a refrigerator and electric hotplates. All cabins have a water supply to the kitchen sink and drain. The cabins L5, L5-1 and Adria include bath and toilet. Cabins are equipped with crockery and cutlery for 6 people, plus pots and pans. All cabins contain duvets and pillows, but you must bring your own bedlinen (sheets and covers) with you. Smoking is not permitted in the cabins. It is, however, possible to rent bedlinen at certain campsites check with the campsite. The chalets are no-smoking areas

Find prices for cabins and caravans at
www.fdmcamping.dk

Cabins and caravans

- Cozy cabins and caravans

L5-1 · 5 persons · 25 m²

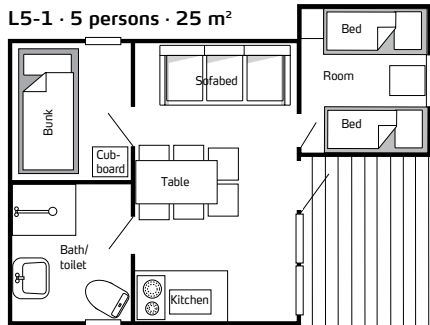

K5-2 · 5 persons · 21,5 m²

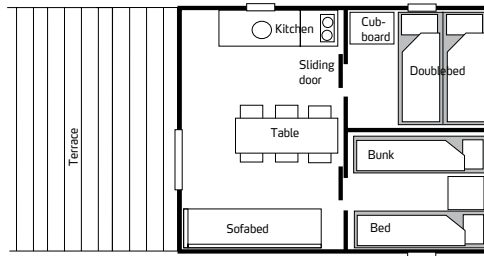

H6 · 6 persons · 21,5 m²

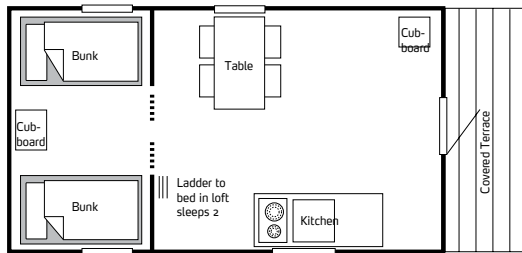

S8 · 8 persons · 21,5 m²

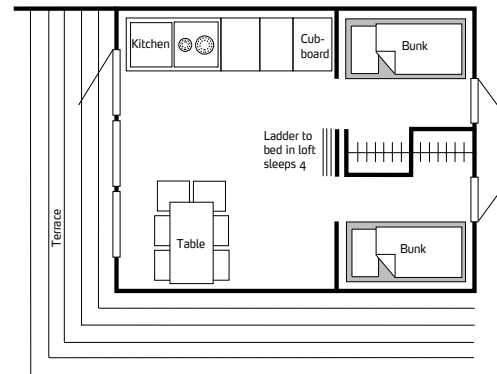

512 up · 4 persons

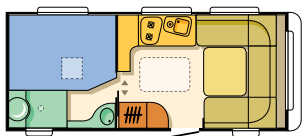

542 pk · 5 persons



563TK · 5 persons

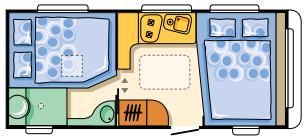

Book online at www.fdm.dk/camping

General terms

for renting cabins and caravans

- Subletting.** FDM members may not sublet cabins/caravans to nonmembers. FDM members may only rent one hut in their own name/ membership and must live in the hut them selves. Membership is personal. Smoking is not permitted in the cabins and caravans.
- Number of visitors.** Caravans and cabins may only be occupied by the number of persons for whom there are beds.
- Arrival and departure.** Arrival must be from 3 to 6 p.m. and departure no later than 11 am.
- Equipment.** All units are equipped with crockery and cutlery. Guests are responsible for all equipment during the period of rental. The camp manager must be reimbursed for any objects which are lost or damaged.
- The Danish climate** is not always reliable, and even the toughest equipment can break in a bad storm. Naturally, the camp manager will help if there is any damage to the unit you have rented, but we cannot guarantee to rehouse you if equipment is completely ruined.
- Cleaning and handing over.** The tenant is responsible himor herself for the cleaning of huts and caravans. Holbæk and Billund have mandatory final cleaning in huts on departure. But we would remind you that all refuse must be sorted. Any shutters in the huts must be closed, and the heating must be turned off. And remember to empty the bucket under the caravan. The key must be delivered to reception on checkout.
- The price includes rent,** an overnight charge for the number of persons registered, and consumption of electricity and gas (not during the winter). Please pay for any visitors at the reception after normal tariff (day guest/overnighting).
- Online booking and payment.** On our homepage www.fdm.dk/camping you can book spots for your own caravan, tent or camper, or you can book a cabin. On some campsites it is also possible to rent a caravan.
- Booking and payment.** Once FDM Camping has confirmed your booking it is binding, and you are liable for the entire rental amount. A deposit of 30% of the total rent must be received by FDM no later than 8 days after you receive confirmation of booking. The remainder must be received by FDM no later than 4 weeks before commencement of the rental period. If you book less than 4 weeks before the rental period commences, the entire rental amount falls due for payment im-mediately. NB! Failure to pay the deposit entitles FDM Camping to cancel your reservation without further notice.
- Cancellation.** If you cancel more than four weeks before the rental period commences, a cancellation charge will be imposed. If you cancel less than four weeks before the rental period commences, a refund will only be made if the unit concerned is rented to someone else. If you cancel because anyone in your group falls ill (doctor's certificate required) the rental amount will be refunded minus the cancellation charge. Guests who move out before the end of the rental period are not entitled to any form of refund.
Right of cancellation and refund by online booking: If you cancel more than 30 days before arrival, the full amount less a reservation fee of DKK 525 will be refunded. If you cancel less than 30 days but more than 7 days before arrival, half of the amount will be refunded. If you cancel less than 7 days before arrival, there is no refund.
- Pets are welcome** against payment. Animals are not allowed to occupy beds or sit on furniture, and dogs must always be kept on a short leash.
- Delayed arrival/failure to arrive.** If you are delayed or prevented from arriving on the day your rental period commences, please contact the camp manager at the campsite concerned before 6 pm. NB: If you book at the last minute without paying, the unit concerned may be rented to someone else after 6 pm if you fail to inform the camp manager of a delay in your arrival.
- A camping permit is required.**

Key to symbols

Star rating symbols

- Toilet/Toilet for hire
- Washbasin - hot/cold water
- Washbasin with door
- Washbasin closed on 3 sides
- Shower - hot/cold water/Charge
- Electric point for hairdryers/razors
- Combi room - toilet, washbasin, shower/Charge For hire
- Mini bathroom for families/Charge/For hire
- Bathroom for families/Charge/For hire
- Bathroom Charge/For hire
- Nursing room for babies/Charge
- Sanitary section for children/Charge
- Cooking facilities/Charge
- Opvask med v/k vand/betaling

Activities symbols

- TV
- Satellite TV connection/Charge
- Wireless Internet connection/Charge
- Internet café/Charge
- Safety box/Charge
- Babysitter arrangement/Charge
- Childminding from 3-7 years/Charge
- Activities organiser min. peak season/Charge
- Playground (min. 12 pieces of equipment) max. 1 km from site/Charge
- Activities room max. 1 km from site/Charge
- Games hall max. 1 km from site/Charge
- Animals on site/Charge
- Horse riding max. 1 km from site/Charge
- Skateboard track max. 1 km from site/Charge
- Cyclecross-BMX track max. 1 km from site/Charge
- Mini water park/Charge
- Mini water park under cover/Charge
- Water park with 5 activities, 25° pools max. 5 km from site/Charge
- Water park with 5 activities, 25° pools under cover max. 5 km from site/Charge
- Swimming pool unheated Charge
- Swimming pool unheated under cover/Charge
- Swimming pool heated/Charge
- Swimming pool heated under cover/Charge
- Swimming pool 200 m² heated/Charge
- Swimming pool 200 m² under cover heated/Charge
- Children's pool unheated/Charge
- Children's pool unheated under cover/Charge
- Children's pool heated/Charge
- Children's pool heated under cover/Charge
- Slide min. 10 m/Charge
- Slide min. 10 m under cover/Charge
- Spa-Jacuzzi/Charge
- Sauna/Charge
- Solarium/Charge
- Fitness room min. 5 pieces of equipment/Charge
- Petanque/Charge
- Beach volley/Charge
- Minigolf/Charge
- Playing field
- Badminton/Charge
- Volleyball

Information symbols

- Poor shelter
- Good shelter
- Excellent shelter
- Fenced - with bar and permanent supervision
- Kiosk max. 1 km from site
- Shop max. 1 km from site
- Café max. 1 km from site
- Grill bar max. 1 km from site
- Cafeteria max. 1 km from site
- Restaurant max. 1 km from site
- Section for light campers
- Tents for hire
- Caravans for hire
- Cabins category I - for hire (quantity)
- Cabins category II - for hire (quantity)
- Cabins category III - for hire (quantity)
- Cabins category IVa - for hire (quantity)
- Cabins category IVb - for hire (quantity)
- Cabins category Va - for hire (quantity)
- Cabins category Vb - for hire (quantity)
- Rooms to let
- No cars
- No caravans
- No dogs
- Telephone/Charge
- Telephone and telefax messages received and sent/Charge
- Booking/Charge
- Payment by credit card - free/Charge
- Winter camping
- Winter camping - registration required
- Naturism

- Level and reinforced pitches with mains water/Charge
- Level and reinforced pitches with waste water drain/Charge
- Level and reinforced pitches with waste water drain and mains water/Charge
- Komfortpladser/betaling
- Bathing pier max. 1 km from site
- Pedalos for hire - free/Charge
- Windsurfing max. 1 km from site
- Windsurfing equipment for hire free/Charge
- Suggested cycling tours in nearby area, folder/min. 3 - length of route min. 10 km
- Cycles for hire - free/Charge
- Suggested walking tours in nearby area, folder/min. 3 - length of route min. 3 km
- Nature walks with guide - min. peak season, max. 5 km from site/Charge
- Exercise track min. 10 obstacles, max. 1 km from site/Charge
- Exercise excursions with guide - min. peak season, max. 5 km from site/Charge
- Organised tours by bus and similar lign. arrangements - min. peak season, max. 5 km from site/Charge
- Pitch size - unspecified
- Pitch size ≤79 m² (quantity)
- Pitch size ≥80≤99 m² (quantity)
- Pitch size ≥100≤119 m² (quantity)
- Pitch size ≥120 m² (quantity)
- Sanitary capacity
- Free space
- Approved area in hectares/no. of pitches/of permanent pitches/number of powerpoints

Thema

- Cycling
- Diving
- Animals
- Angling
- Wellness
- Windsurfing
- Cycling
- Environment
- Caravans
- Activities
- Urban camping
- Camp school
- Kayak/canoe
- Golf
- Peace and quiet
- Conference



Ålbæk Strand Camping

Jerupvej 19 · 9982 Ålbæk
 Tel.: 98 48 82 61 · Fax 98 48 89 34
 www.aalbaek.fdmcamping.dk

Hegedal Strand Camping

Ravnvej 3 · Fjellerup · 8585 Glesborg
 Tel.: 86 31 77 50 · Fax 86 31 77 40
 www.hegedal.fdmcamping.dk

Billund Camping

Ellehammers Allé 2 · 7190 Billund
 Tel.: 75 33 15 21 · Fax 75 35 37 36
 www.billundcamping.dk

Thurø Camping

Srømosevej 7 · Thurø · 5700 Svendborg
 Tel.: 62 20 52 54 · Fax 62 20 52 78
 www.thuroe.fdmcamping.dk

Nykøbing Nordstrand camping

Nordstrandsvej 107 · 4500 Nykøbing Sj
 Tel.: 59 91 16 42 · Fax 59 91 47 74
 www.nykoebing.fdmcamping.dk

Holbæk Fjord Camping og Wellness

Sofiesminde Allé 1 · 4300 Holbæk
 Tel.: 59 43 50 64 · Fax 59 43 50 14
 www.holbaek.fdmcamping.dk

Tangloppen Camping

Ishøj Havn · 2635 Ishøj
 Tel.: 43 54 07 67 · Fax 43 54 07 64
 www.tangloppen.fdmcamping.dk

Østersøparken Camping

Bøtøvej 243 · Bøtø · 4873 Væggerløse
 Tel.: 54 13 67 86 · Fax 54 13 61 90
 www.oestersoe.fdmcamping.dk

Bjerge Sydstrand Camping

Osvejen 30 · 4480 Store Fuglede
 Tel.: 59 59 78 03
 www.bjerge.fdmcamping.dk

Skive Fjord Camping

Marienlyst Strand 15-16 · 7800 Skive
 Tel.: 97 51 44 55 · Fax 97 51 44 75
 www.skivefjordcamping.dk

Hovedkontor:

Firskovvej 32 · 2800 Kgs. Lyngby
 Tel. (+45) 45 27 07 07
 Fax (+45) 45 27 09 91
 camping@fdm.dk
 www.fdmcamping.dk

